

1980-86 Ford F100-350 Optional Dual Fuel Tank Harness

In this kit, you will find all the harness components necessary to make the connections needed if your truck has dual fuel tanks. Please use the directions on this page as well as the drawings and notes on page 2 of this instruction set to install your new American Autowire optional dual fuel tank harness. There are two different main dash switch connections, and both are included with this kit. You will plug one or the other onto your main switch. The one not plugged in will just remain intact behind the dash and will not be used.

Directions:

1. This wiring harness should be installed onto the removed dash frame assembly of your truck along with your dash harness prior to installing the completed dash frame assembly back into the truck.
2. Plug the tank selector switch connector at branch 1 on the "Dual Fuel Tank Wiring Assembly A" onto the main dash mounted switch. Please note that there are two different switch configurations (1980-85 and 1986). Be sure to choose the proper connection for your application.
3. Route the purple (no printing) and tan (gas gauge) wires at branch 2 of the "Dual Fuel Tank Wiring Assembly A" harness over to the dash cluster area and plug them into the mating connectors of the tan "gas gauge" wires of the 510725 dash/main harness shown on page 7, photograph 8.
4. Route the "Dual Fuel Tank Wiring Assembly A" harness over near the fuse box area and plug the 6 position connector at branch 3 containing the two tan wires into the optional accessory connector plug of the dash/main harness (510725) shown on page 9, photograph 14 (you will need to remove the existing mating plug from the accessory connector that was plugged in at the factory prior to installing this new connector). If your truck also has an electric fuel pump, or if you require another 12 volt ignition fused power feed, please use the 4" tan pigtail wire that is doubled up in the 6-position connector to make your connection. This connection is shown on page 2 of this instruction set. If needed, the terminals to make this extra plug-in connection are located in the loose piece parts kit of the 510725 dash kit.
5. Also located at branch 3 with the 6-position connector containing the two tan wires is a black wire with a ring terminal. You must attach this to a good known ground for the system to operate properly.
6. Next, route the long white "gas gauge aux tank" and black "ground" wires from branch 3 in this kit out through the LH firewall grommet, over to the auxiliary fuel tank area, cut them to length, install terminals D, and plug into connector E as shown on page 2 of this instruction set. Plug connector E into either the "Auxiliary Fuel Gauge Sender Jumper B" (1980-84 applications) or the "Auxiliary Fuel Gauge Sender Jumper C" (1985-86 applications) as shown on page 2 of this instruction set to complete this circuit. Plug the completed jumper assembly onto your auxiliary fuel tank sender.
7. Lastly, route the brown (no printing) and black "ground" wires from branch 3 in this kit out through the LH firewall grommet, over to the fuel control solenoid area, cut them to length, install terminals D, and plug into connector E as shown on page 2 of this instruction set. Your original fuel control solenoid has brown/white stripe and black wires coming out of it. Cut the factory connector off of these wires as close to the back of the connector as possible leaving you with the maximum amount of wire. Install terminals G, and plug into connector F as shown on page 2 of this instruction set. Plug connector E into connector F maintaining color continuity with black to black and brown to brown/white stripe to complete your connection.
8. Your installation is now complete.

The kit consists of the following:

1. Dual Fuel Tank Wiring Assembly A.
2. '80-'84 Fuel Tank Extension B.
3. '85-'86 Fuel Tank Extension C.
4. (7) female terminals D.
5. (2) female connector E.
6. (1) male connector F.
7. (3) male terminals G.



**American
Autowire**

www.americanautowire.com 856-933-0801

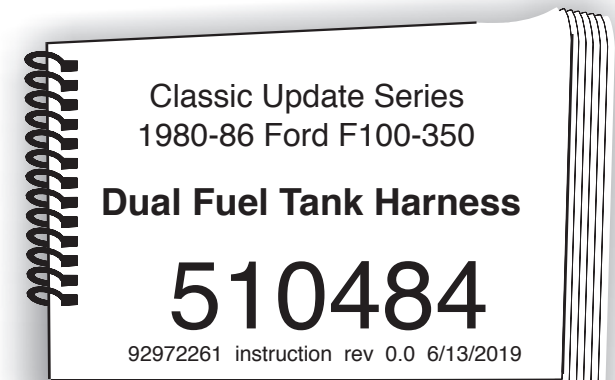



**American
Autowire**

www.americanautowire.com 856-933-0801

If you have an electric fuel pump, or need an additional ignition fused accessory, plug it into this pigtail.

Plug this connector into the optional accessory connector plug shown on page 9, photograph 14 (and details on page 10) of the 510724 main instruction set.

Plug these connectors into the two mating connectors containing the tan fuel gauge lead wires from the dash harness, 510725. These can be seen on page 7, photograph 8 of the main instruction set, 510724.

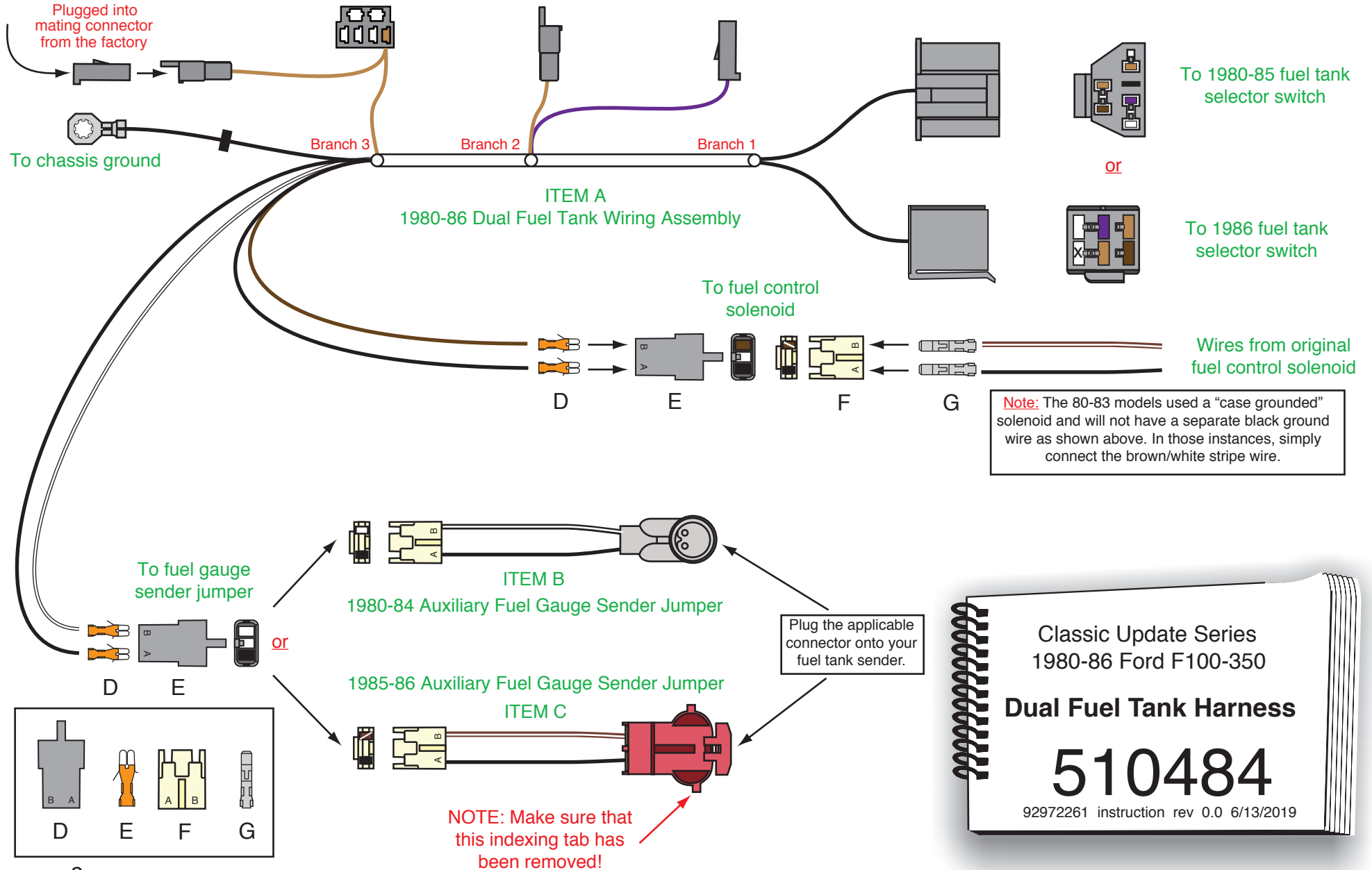

Classic Update Series
1980-86 Ford F100-350

Dual Fuel Tank Harness

510484

92972261 instruction rev 0.0 6/13/2019